

Table of Contents

How to use monitoring 1

Event Log 1

Real-Time Log 2

Device Status 2

Door Status 3

Zone Status 4

Alert History 5

[System Configuration](#), [BioStar 2](#), [Monitoring](#)

How to use monitoring

In the monitoring, six different sub monitoring types are supported to support each category of events more easily detected and noticed.

Event Log

All the events are listed, but it's not updated automatically and needs to be refreshed to display new events.

When to use: Event Log is designed for fast and easy specific past event search. Set the filter and save it for easy search and selected event display

1. Click funnel shaped icon on the each column and check event types to be filtered and searched.

Event Log				
Save Filter				
Date	Device ID	Device	User	Event
2015/09/07 00:00	15	BioLitelet 538101264 (192.168.16.210)	123456789(Jason)	
2015/09/14 23:59		BioStation 2 100000007 (192.168.16....)	2(-)	
		BioEntryW 15 (192.168.16.144)	3(-)	
2015/09/11 16:05:20	15	BioEntryW 15 (192.168.16.144)	3(-)	IDENTIFY_SUCCESS_FINGERPRINT
2015/09/11 16:05:15	15	BioEntryW 15 (192.168.16.144)	2(-)	IDENTIFY_SUCCESS_FINGERPRINT
2015/09/11 16:05:09	15	BioEntryW 15 (192.168.16.144)	123456789(Jason)	IDENTIFY_SUCCESS_FINGERPRINT
2015/09/11 16:05:05	15	BioEntryW 15 (192.168.16.144)	3(-)	IDENTIFY_SUCCESS_FINGERPRINT
2015/09/11 16:04:54	15	BioEntryW 15 (192.168.16.144)	2(-)	IDENTIFY_SUCCESS_FINGERPRINT
2015/09/11 16:03:57	15	BioEntryW 15 (192.168.16.144)	123456789(Jason)	IDENTIFY_SUCCESS_FINGERPRINT
2015/09/11 16:03:51	15	BioEntryW 15 (192.168.16.144)	2(-)	IDENTIFY_SUCCESS_FINGERPRINT
2015/09/11 16:03:48	15	BioEntryW 15 (192.168.16.144)	2(-)	IDENTIFY_SUCCESS_FINGERPRINT
2015/09/11 16:03:45	15	BioEntryW 15 (192.168.16.144)	3(-)	IDENTIFY_SUCCESS_FINGERPRINT
2015/09/11 16:03:41	15	BioEntryW 15 (192.168.16.144)	123456789(Jason)	IDENTIFY_SUCCESS_FINGERPRINT
2015/09/11 16:03:30	15	BioEntryW 15 (192.168.16.144)	2(-)	IDENTIFY_SUCCESS_FINGERPRINT
2015/09/11 16:03:17	15	BioEntryW 15 (192.168.16.144)	2(-)	IDENTIFY_SUCCESS_FINGERPRINT
2015/09/11 16:03:14	15	BioEntryW 15 (192.168.16.144)	2(-)	IDENTIFY_SUCCESS_FINGERPRINT
2015/09/11 16:03:11	15	BioEntryW 15 (192.168.16.144)	123456789(Jason)	IDENTIFY_SUCCESS_FINGERPRINT
2015/09/11 16:03:09	15	BioEntryW 15 (192.168.16.144)	123456789(Jason)	IDENTIFY_SUCCESS_FINGERPRINT

2. The filtered combination can be saved and referred as a fixed search option.

Event Log														
<ul style="list-style-type: none"> Event Log Test Test2 Test3 Real-time Log Device Status Door Status Zone Status Alert History 	<div>Save Filter</div> <table> <tr> <th>Date</th><th>Device ID</th><th>Device</th></tr> <tr> <td>2015/09/07 00:00</td><td>15</td><td>BioLiteNet 538101264 (192.168.16.210)</td></tr> <tr> <td>2015/09/14 23:59</td><td>100000007</td><td>BioStation 2 100000007 (192.168.16....)</td></tr> <tr> <td></td><td></td><td>BioEntryW 15 (192.168.16.144)</td></tr> </table>		Date	Device ID	Device	2015/09/07 00:00	15	BioLiteNet 538101264 (192.168.16.210)	2015/09/14 23:59	100000007	BioStation 2 100000007 (192.168.16....)			BioEntryW 15 (192.168.16.144)
Date	Device ID	Device												
2015/09/07 00:00	15	BioLiteNet 538101264 (192.168.16.210)												
2015/09/14 23:59	100000007	BioStation 2 100000007 (192.168.16....)												
		BioEntryW 15 (192.168.16.144)												

Real-Time Log

Update and display events in real-time. But, as it has a page limit for event display, only the latest events are remained to be displayed.

When to use: to check the system events in real time for current event monitoring purpose. Note that refreshing browser clears event data on the display.

Real-time Log				
Save Filter				
Date	Door	Device ID	Device	User
2015/09/14 09:23:39	Test	15	BioEntryW 15 (192.168.16.1...	
2015/09/14 09:23:36	Test	15	BioEntryW 15 (192.168.16.1...	
2015/09/14 09:23:36		15	BioEntryW 15 (192.168.16.1...	2
2015/09/14 09:23:30		538101264	BioLiteNet 538101264 (192....	Jason
2015/09/14 09:23:31	Test	15	BioEntryW 15 (192.168.16.1...	
2015/09/14 09:23:31		15	BioEntryW 15 (192.168.16.1...	Jason
2015/09/14 09:23:26		100000007	BioStation 2 100000007 (19...	Jason
2015/09/14 09:23:23		100000007	BioStation 2 100000007 (19...	Jason

Device Status

Display the device status with device related alarm events and clear option.

When to use: Verify the device status, such as device connection and device level alarm events.

Device Alarm : Supervised Input, Tamper, RS485_Disconnected, System Reset

Device Status			
Save Filter			
	Device Name	Device Status	Alarm
<input type="checkbox"/>	BioEntryW 15 (192.168.16.144)	Normal	
<input type="checkbox"/>	BioLiteNet 538101264 (192.168.16.210)	Normal	
<input type="checkbox"/>	BioStation 2 100000007 (192.168.16.205)	Normal	

Door Status

Display the door status with relay status and door control options

When to use: Check the relay status and manage doors manually from the client browser to open or lock the doors

Door Control Buttons

- **Lock:** Lock the door relay and not allow to open it until 'Unlock' or 'Open' button from BioStar 2 client is pressed
- **Unlock:** Unlock the door relay and not allow to be locked or normal until 'Lock' or 'Open' button from BioStar 2 client is pressed
- **Open:** Open the door relay during the predefined time period
- **Clear Alarm:** Acknowledging and clear door related alarm events, such as forced/held open alarm and one door APB
- **Clear APB:** Clear one door APB violation and users' In/Out status and make it to be the default status, which means users can enter the door regardless of their previous In/Out event.

Door Status						
Save Filter		<div> <div>Lock</div> <div>Unlock</div> <div>Open</div> <div>Clear Alarm</div> <div>Clear APB</div> </div>				
<input checked="" type="checkbox"/>	Door Name	Door Status	Door Relay	Alarm	Last Event	
<input checked="" type="checkbox"/>	BS2	Closed	Locked			
<input checked="" type="checkbox"/>	Test	Closed	Locked			

Zone Status

Display the zone status and its alarm on/off options

- When to use: Check the zone status and release zone related alarms
- Zone Alarms: Local APB, FireAlarm
- Note: In order to use 'Zone', the standard edition license needs to be activated. And if you refresh and move to another tap, the last event is cleared from the browser.

1. When APB violation event occurs, the zone shows the last event with the user name who violates a APB rule.

Zone Status						
Save Filter						
<input type="checkbox"/>	Type	Zone Name	Active/Inactive	Status	Alarm	Last Event
<input type="checkbox"/>	Anti-passback	APB	Active	Normal		15:24 APB_VIOLATION_HARD - Jason
<input type="checkbox"/>	Fire Alarm	Fire	Active	Normal		

2. Click the APB zone and click **Clear APB** if it's necessary to reset the APB status.

Note that the clear APB sets the zone to be the default status of allowing all the users entering the door regardless of their previous status. And the individual APB reset will be supported from the future updated version.

Zone Status						
Save Filter		<div> <div>Clear APB</div> <div>Clear Alarm</div> <div>...</div> </div>				
<input checked="" type="checkbox"/>	Type	Zone Name	Active/Inactive	Status	Alarm	Last Event
<input checked="" type="checkbox"/>	Anti-passback	APB	Active	Normal		15:24 APB_VIOLATION_HARD - Jason
<input type="checkbox"/>	Fire Alarm	Fire	Active	Normal		

Alert History

BioStar 2 supports acknowledge memo options to receive the selected alert events and take a memo for future reference

When to use: Check the past alert history and actions taken to handle the alarm events.
In order to receive alerts, the events should be set to make an alert from the global setting.

1. Go to the global setting and click **Alert**.

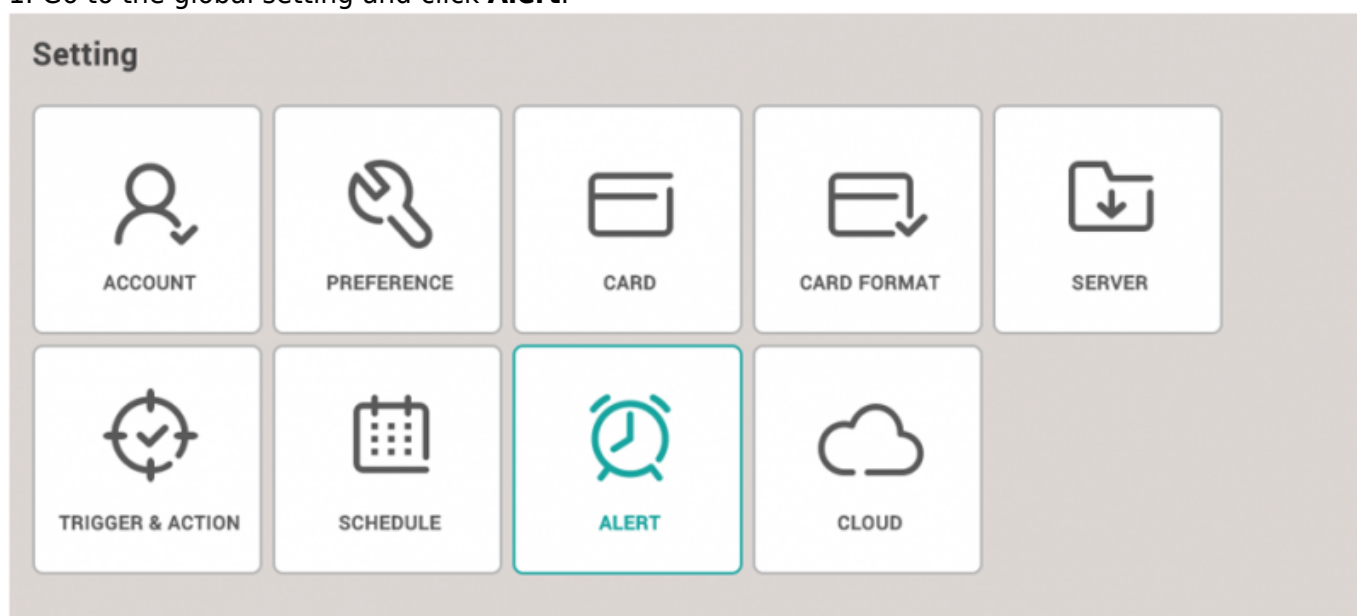

2. Mark the events to be alerted and click **Apply**.

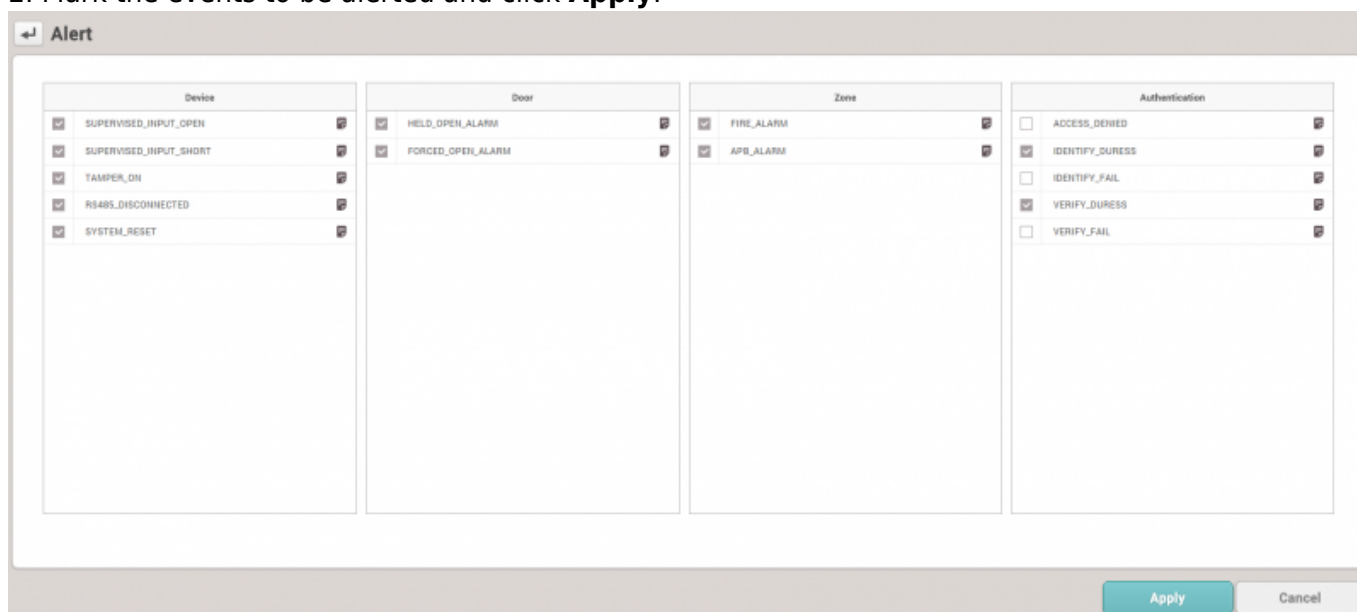

3. Check the alert message box and type the actions taken in the memo section.

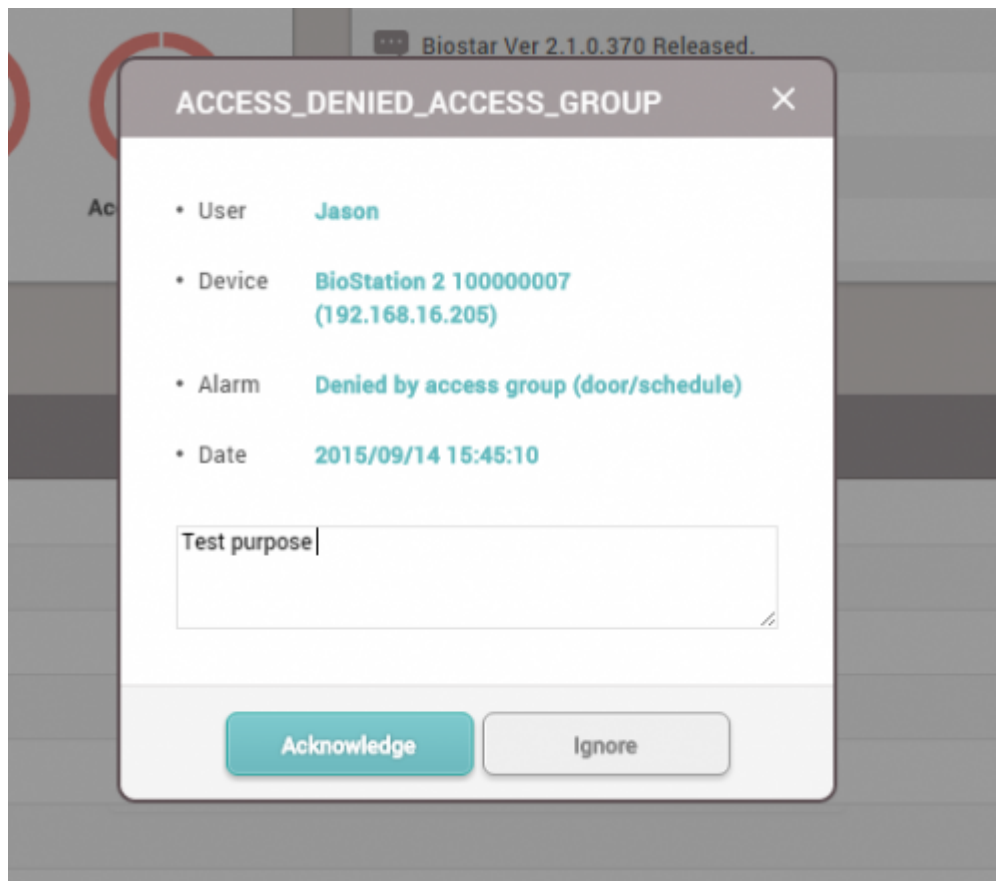

4. Go to **MONITORING**, and go to **Alert History** and click the memo icon in the status section. You can see the note taken to handle this event.

Alert History 1-12/12

Save Filter

Date	Device	User	Alarm	Ack. By	Status
2015/09/14 15:45:10	BioStation 2 100000007 (192.168.1...	Jason	ACCESS_DENIED_ACCESS_GROUP	Administrator	2015/09/14 15:47
2015/09/09 16:07:02	BioLiteNet 538101264 (192.168.16...		FORCED_OPEN_ALARM	Adminis	
2015/09/07 15:38:28	DoorModule20 1000000030		RS485_DISCONNECTED	Adminis	
2015/08/26 14:07:32	BioEntryW 15		IDENTIFY_FAIL_FINGERPRINT	Adminis	
2015/08/06 10:03:13	BioEntryW 15		FIRE_ALARM	Administrator	2015/08/06 10:03
2015/08/06 10:02:55	BioEntryW 15		FIRE_ALARM	Administrator	2015/08/06 10:03
2015/08/06 09:50:32	BioLiteNet 538101264 (192.168.16...		APB_ALARM	Administrator	2015/08/06 09:50
2015/08/06 09:44:34	BioEntryW 15		FIRE_ALARM	Administrator	2015/08/06 09:44

From:

<http://kb.supremainc.com/knowledge/> -

Permanent link:

http://kb.supremainc.com/knowledge/doku.php?id=en:how_to_use_monitoring

Last update: **2016/07/08 13:34**