

# Table of Contents

- Added Hide Face Credential Preview Image Option ..... 1
- How to apply the 'Hide Face Credential Preview Image' function ..... 1
- How it shows after applying 'Hide Face Credential Preview Image' ..... 2
- 1) Face credential: FaceStation 2, FaceLite ..... 2
- 2) Visual Face credential: FaceStation F2 ..... 3
- 3) Smart card with Visual Face credential: FaceStation F2 ..... 5

# Added Hide Face Credential Preview Image Option

<b>Affect Products &amp; Versions</b>	
<b>BioStar 2</b>	BioStar v2.8.16 or above

On the sites where face credentials are used, there were requests to block the preview of a user's face credential to protect user privacy reasons. Suprema supports the function that does not show the preview of the face credential from BioStar 2.8.16 by reflecting the market requirements.

## How to apply the 'Hide Face Credential Preview Image' function

1. Login BioStar 2 server and go to [Settings > Server > User/Device Management] part.
2. Active 'Hide Face Credential Preview Image' by toggle..

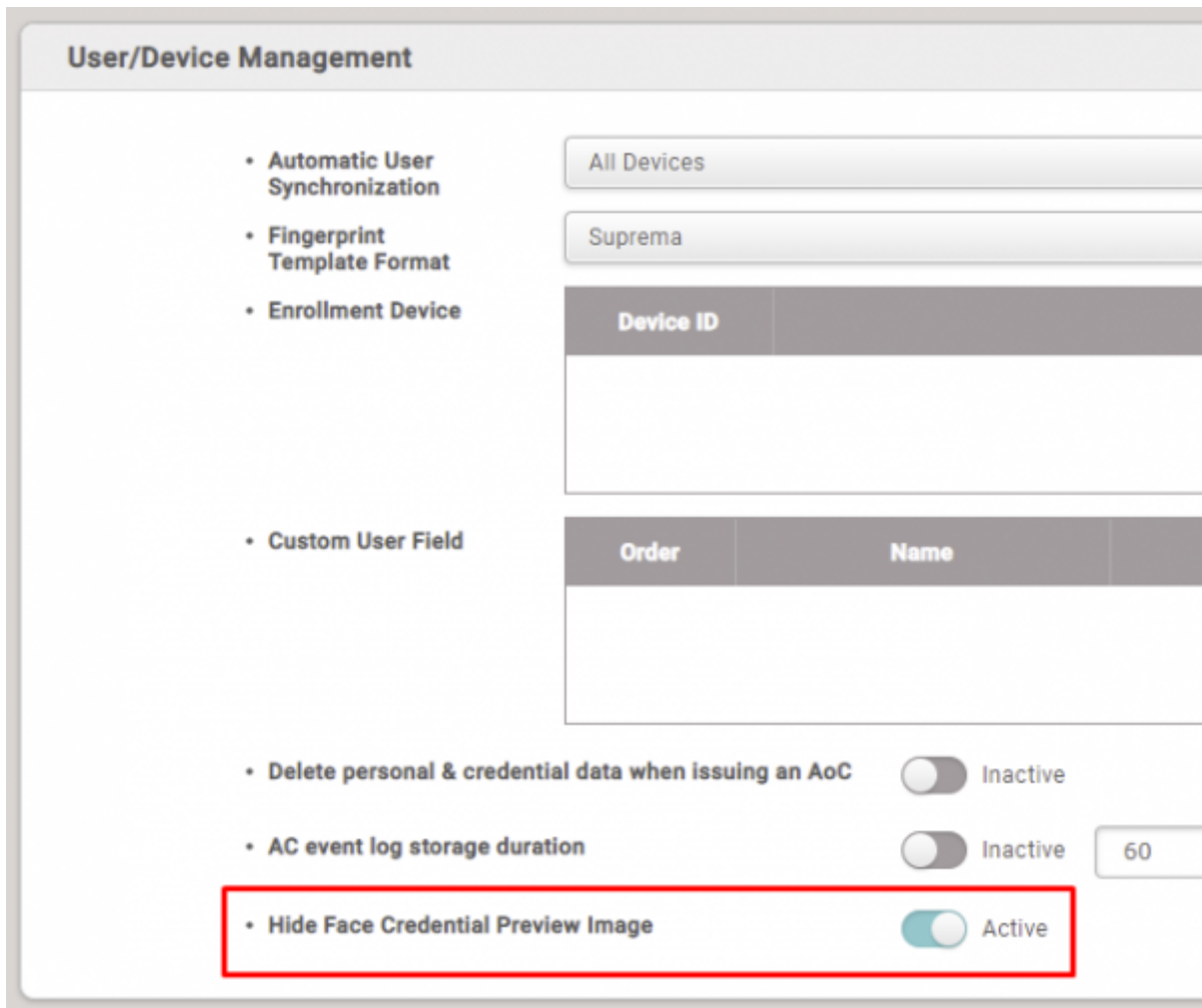

# How it shows after applying 'Hide Face Credential Preview Image'

## 1) Face credential: FaceStation 2, FaceLite

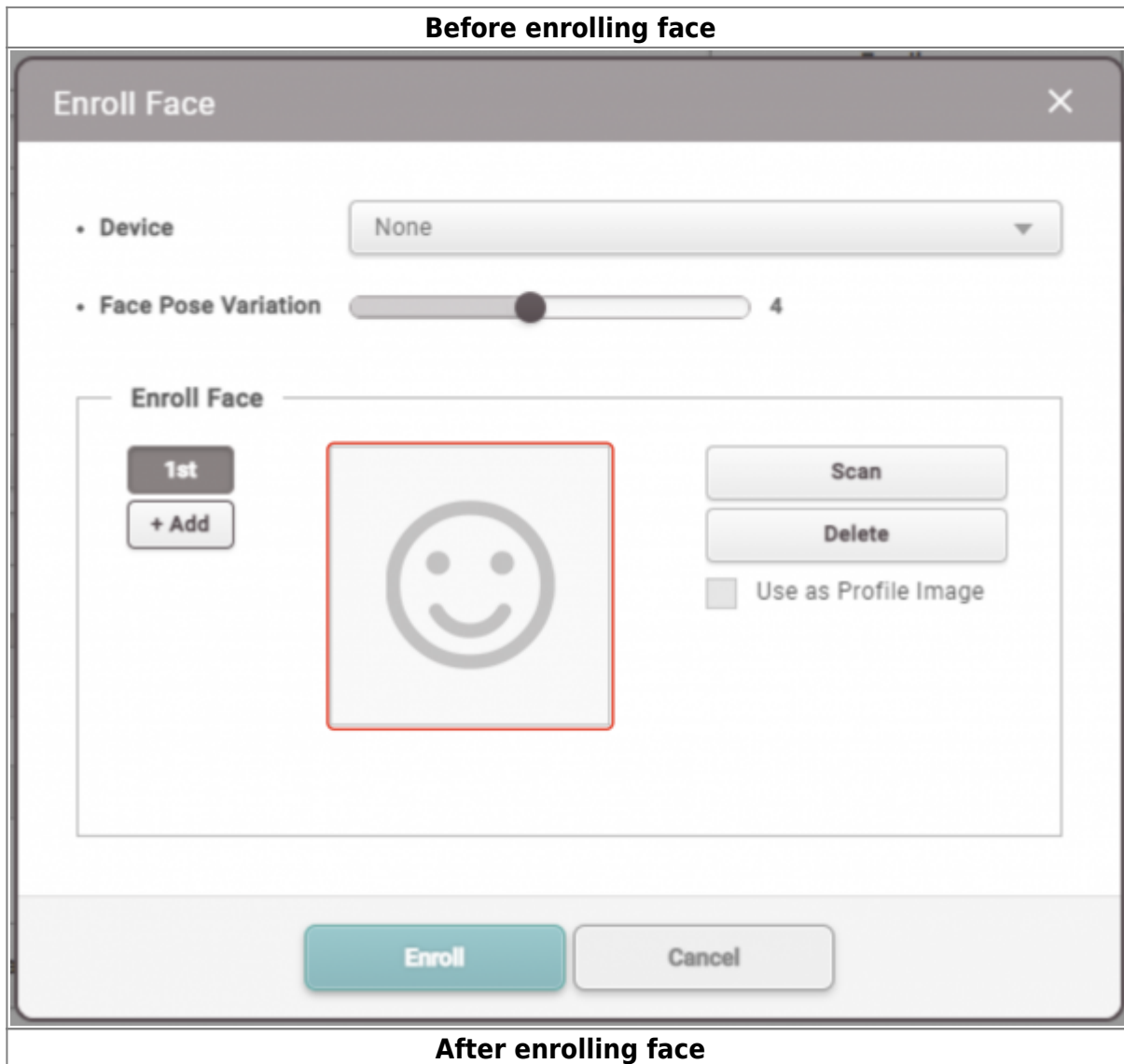

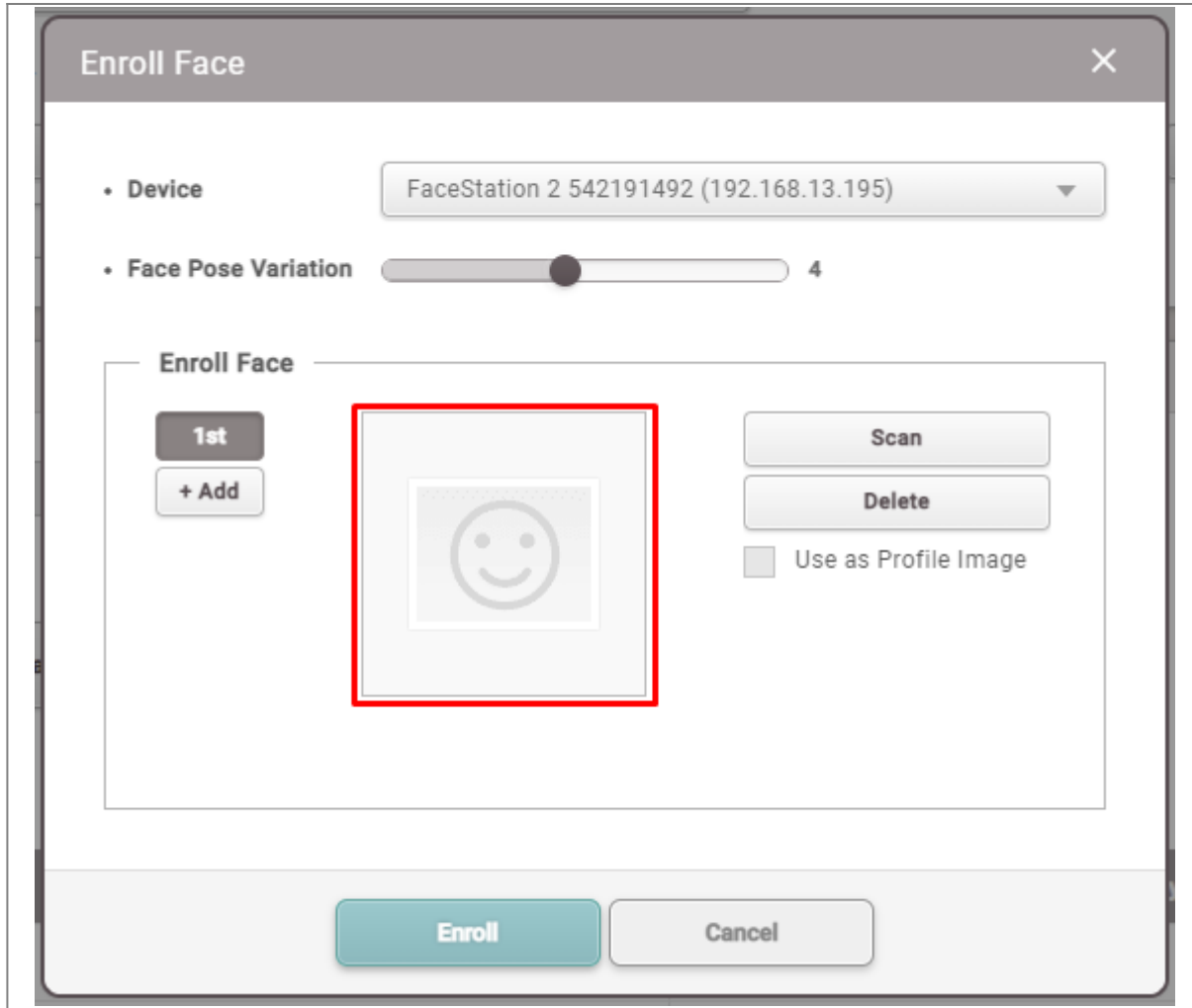

## 2) Visual Face credential: FaceStation F2

**Before enrolling visual face**

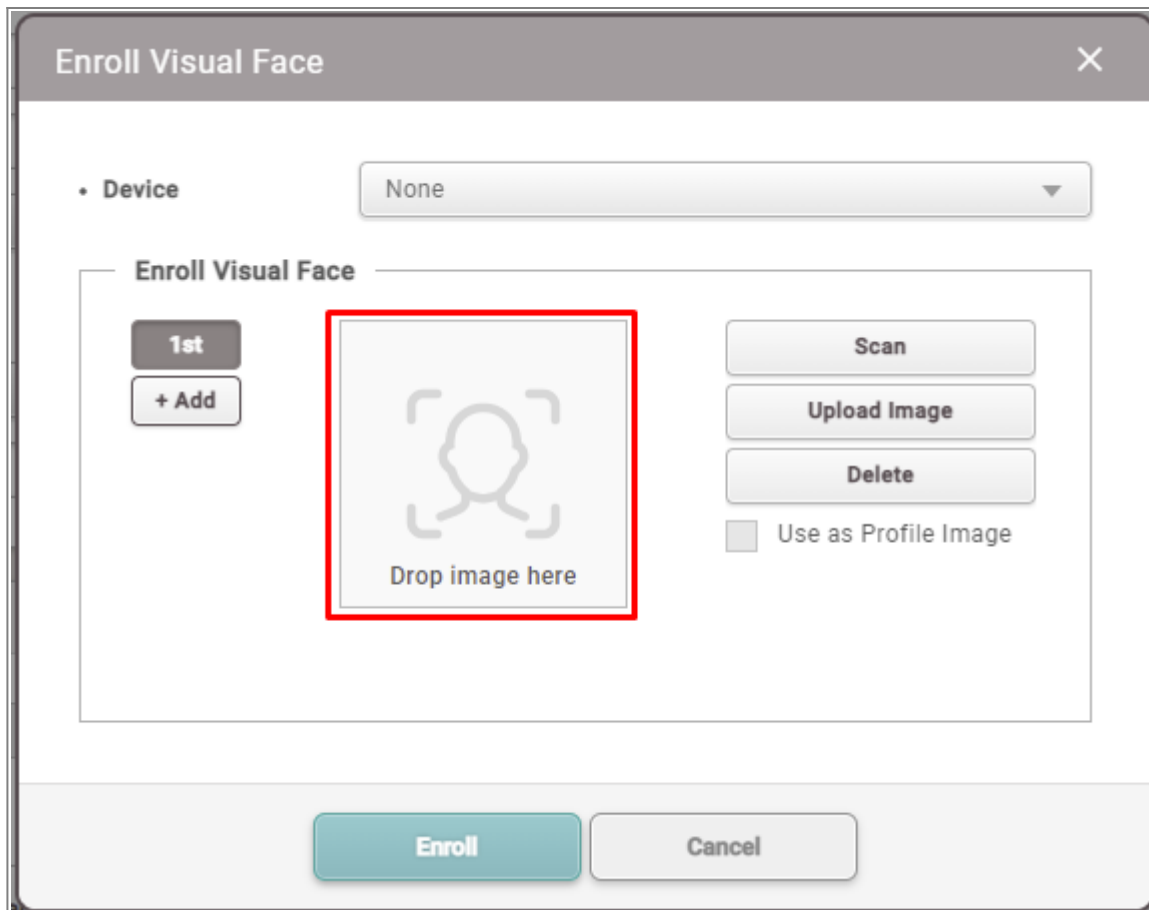

After enrolling visual face

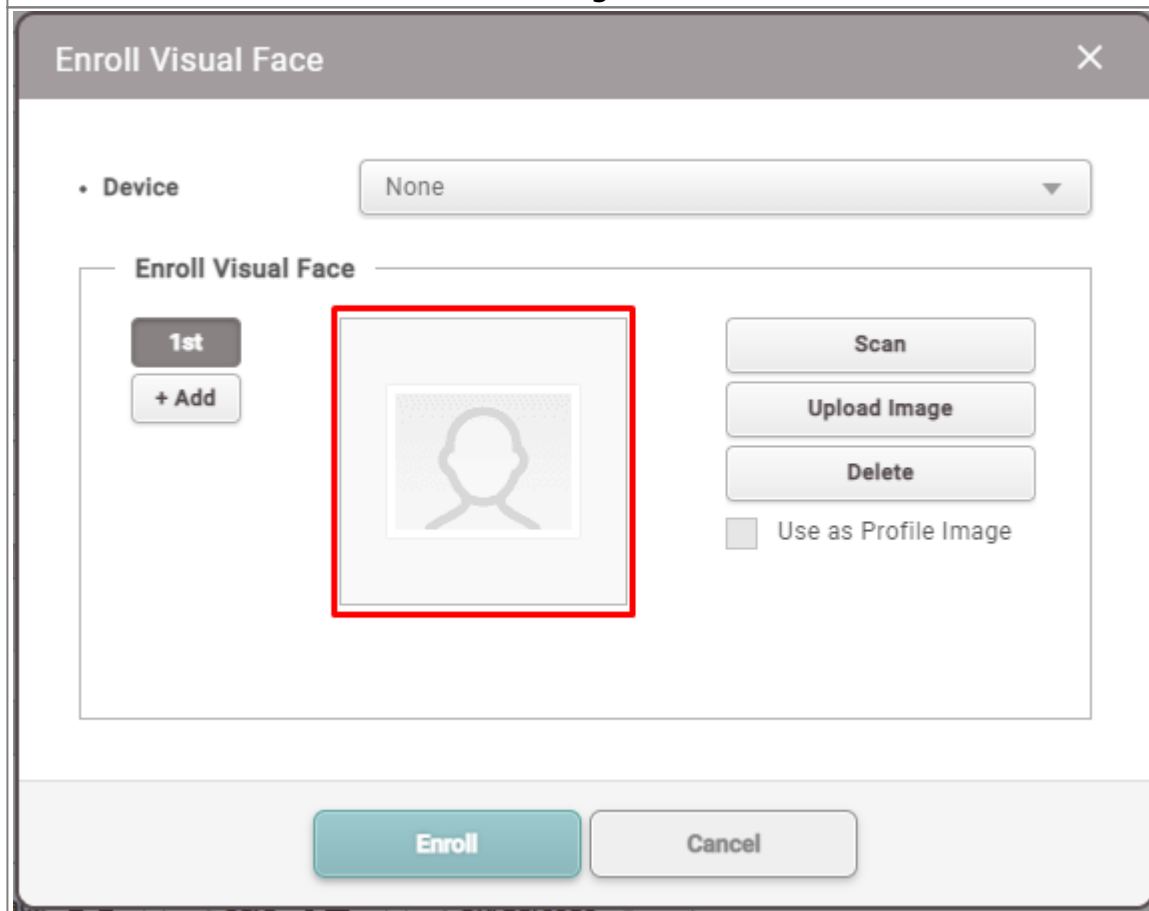

### 3) Smart card with Visual Face credential: FaceStation F2

• Card Type: Smart Card

• Card Layout Format: test

• Device: FaceStation F2 547835928 (192...)

• Smart Card Type: Access On Card

**Information**

• Card ID: 3

• Access Group:

• Face Template:  Use

• Visual Face: 1st

• PIN:

• Period: 2001-01-01 00:00~20...

1st Visual Face



From: <https://kb.supremainc.com/knowledge/> -

Permanent link: [https://kb.supremainc.com/knowledge/doku.php?id=en:added\\_hide\\_face\\_credential\\_preview\\_image\\_option](https://kb.supremainc.com/knowledge/doku.php?id=en:added_hide_face_credential_preview_image_option)

Last update: **2022/04/28 09:19**