

Useful information about the BioEntry W3

How to Install BioEntry W3

Fixing the Bracket and the Product

- 1 Determine the correct position to install the product.

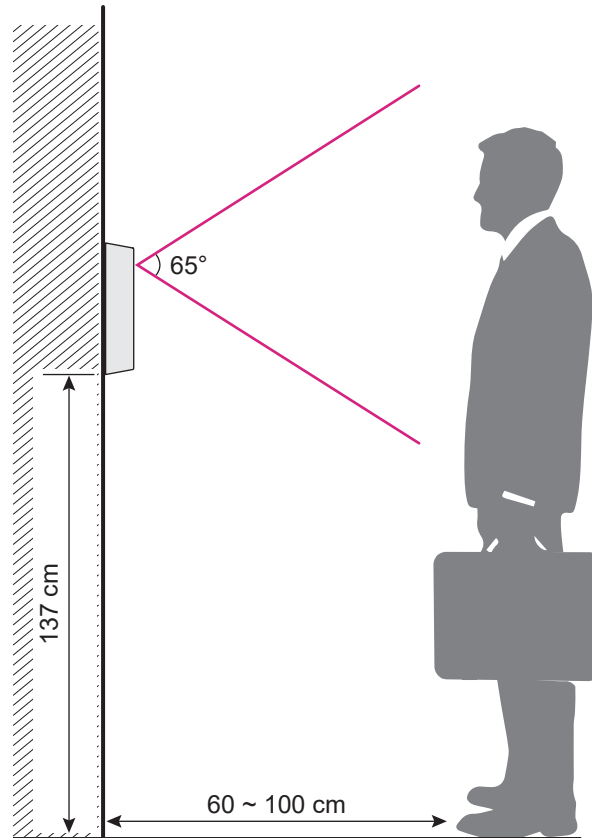

- The optimal height for installing device is 137 cm.
- Install the device where it does not reach the direct sunlight or UV light.
- Adjust the installation position so that the face is not exposed to direct sunlight when a user tries to authenticate.

2 Fix the bracket firmly using fixing screws through the bracket to the position where BioEntry W3 will be installed.

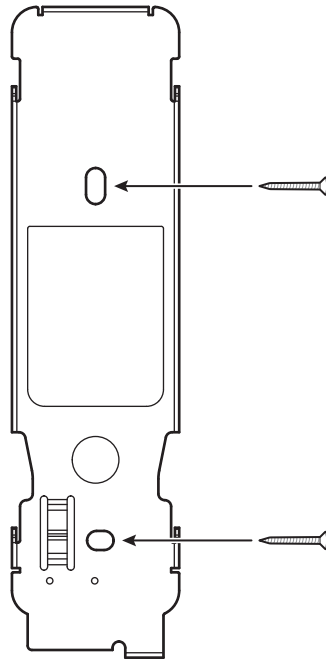

- If installing BioEntry W3 on a concrete wall, drill holes, insert PVC anchors, and fix them with fixing screws.
- To avoid RF interference, a minimum separation distance must be maintained.

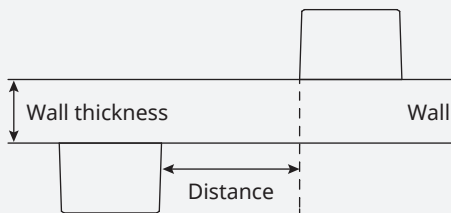

Wall thickness	Distance
100 mm	270 mm
120 mm	250 mm
150 mm	170 mm

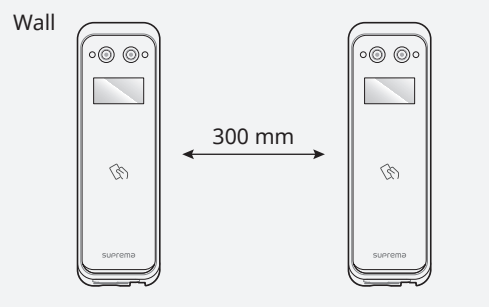

- When using a mobile access card, install devices maintaining a minimum distance of 1 m between devices to avoid BLE interference.

3 Install BioEntry W3 onto the fixed bracket.

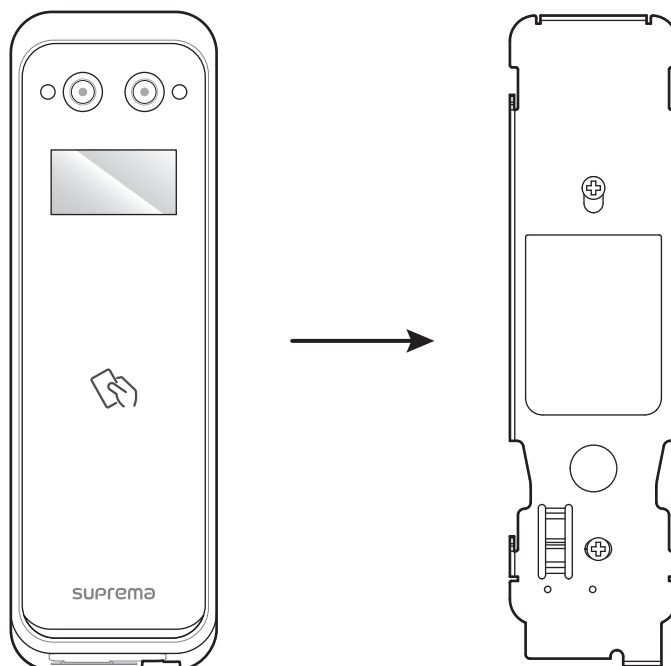

4 Connect BioEntry W3 to the bracket by rotating the product fixing screw of BioEntry W3.

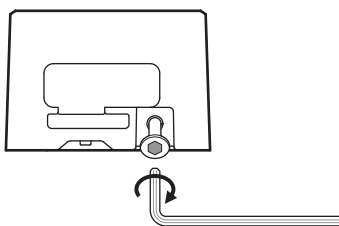

When assembling the product with the bracket, you can use the included bracket fixing screw (Star Shaped) instead of the product fixing screw for enhanced security.

suprema
SECURITY & BIOMETRICS

© 2024 Suprema Inc. Suprema and identifying product names and numbers herein are registered trade marks of Suprema, Inc. All non-Suprema brands and product names are trademarks or registered trademarks of their respective companies. Product appearance, build status and/or specifications are subject to change without notice.